

PLAN

A-A (1 : 2)

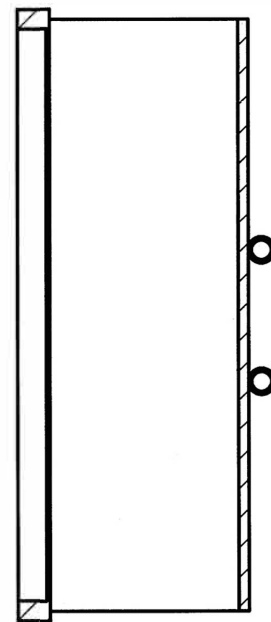

SECTIONAL

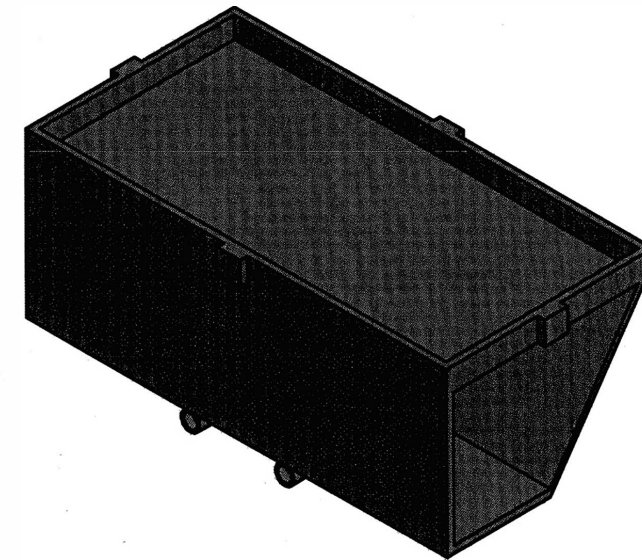

ISOMETRIC

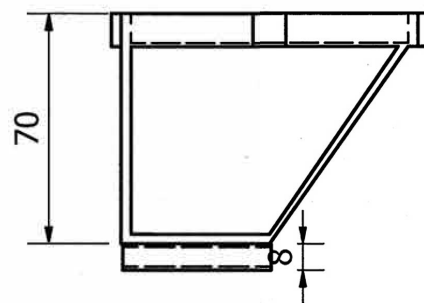

END ELEVATION

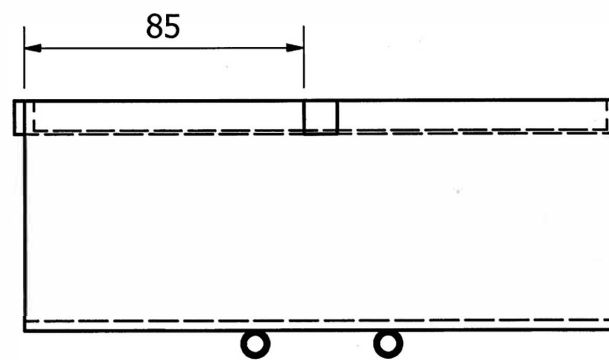

ELEVATION

TASK-1A

NAME:

TITLE:

BACK
CASING

SCALE: 1:2

All sizes in millimetres unless otherwise stated

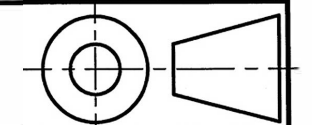

The drawing shows a technical drawing of a front casing. It includes a plan view, an end elevation, a section A-A, and an isometric view. The plan view shows a rectangular shape with a width of 90 and a height of 186. It features two circular holes with a diameter of 60 (Ø60) and four smaller holes. A section line A-A is indicated. The end elevation shows a width of 96 and a height of 13. The section A-A shows a thickness of 3. The isometric view shows the 3D shape of the casing. The elevation view shows a total length of 180 and a height of 13, with a 10-unit wide cutout.

A-A (1:1)

PLAN

END ELEVATION

ELEVATION

ISOMETRIC

TASK - 1A(ii)

NAME:	TITLE: FRONT CASING	SCALE: 1:1	
		All sizes in millimetres unless otherwise stated	

Speaker Disc

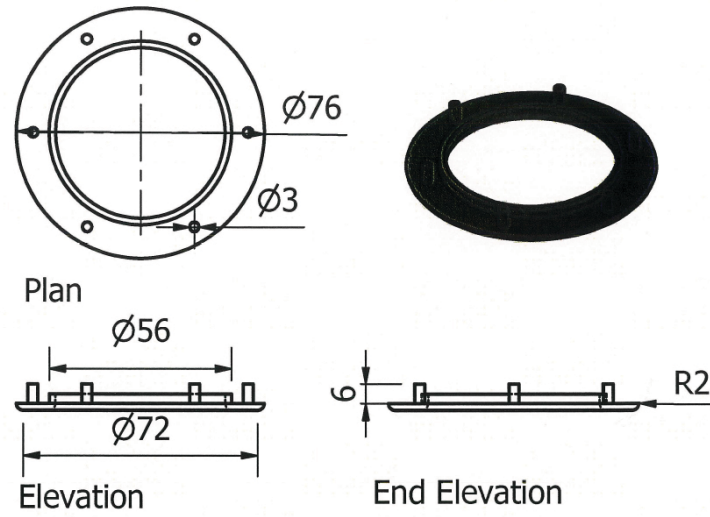

Stabilising Rod

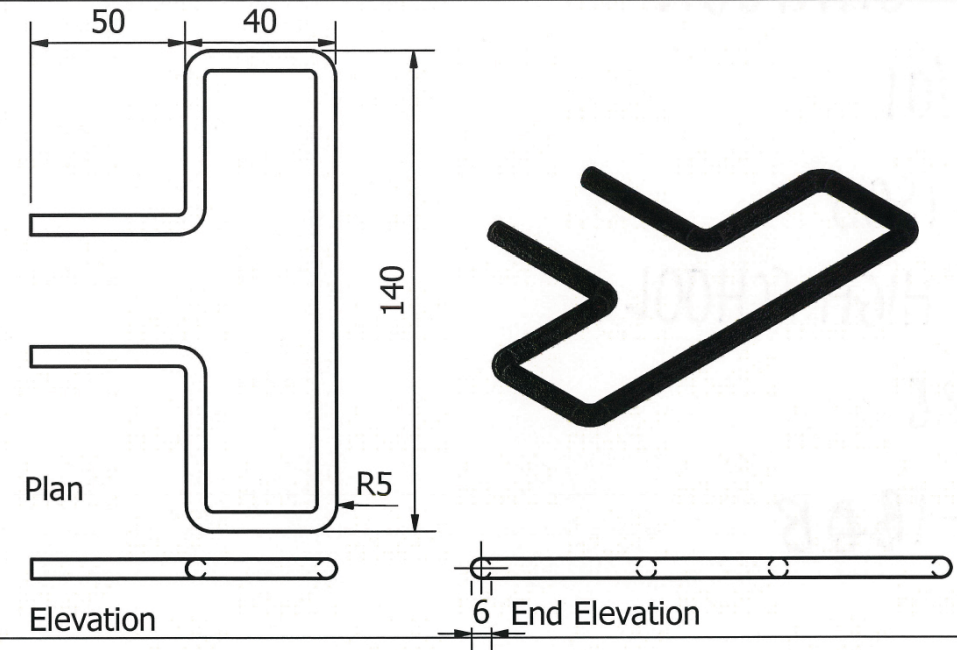

Back Casing

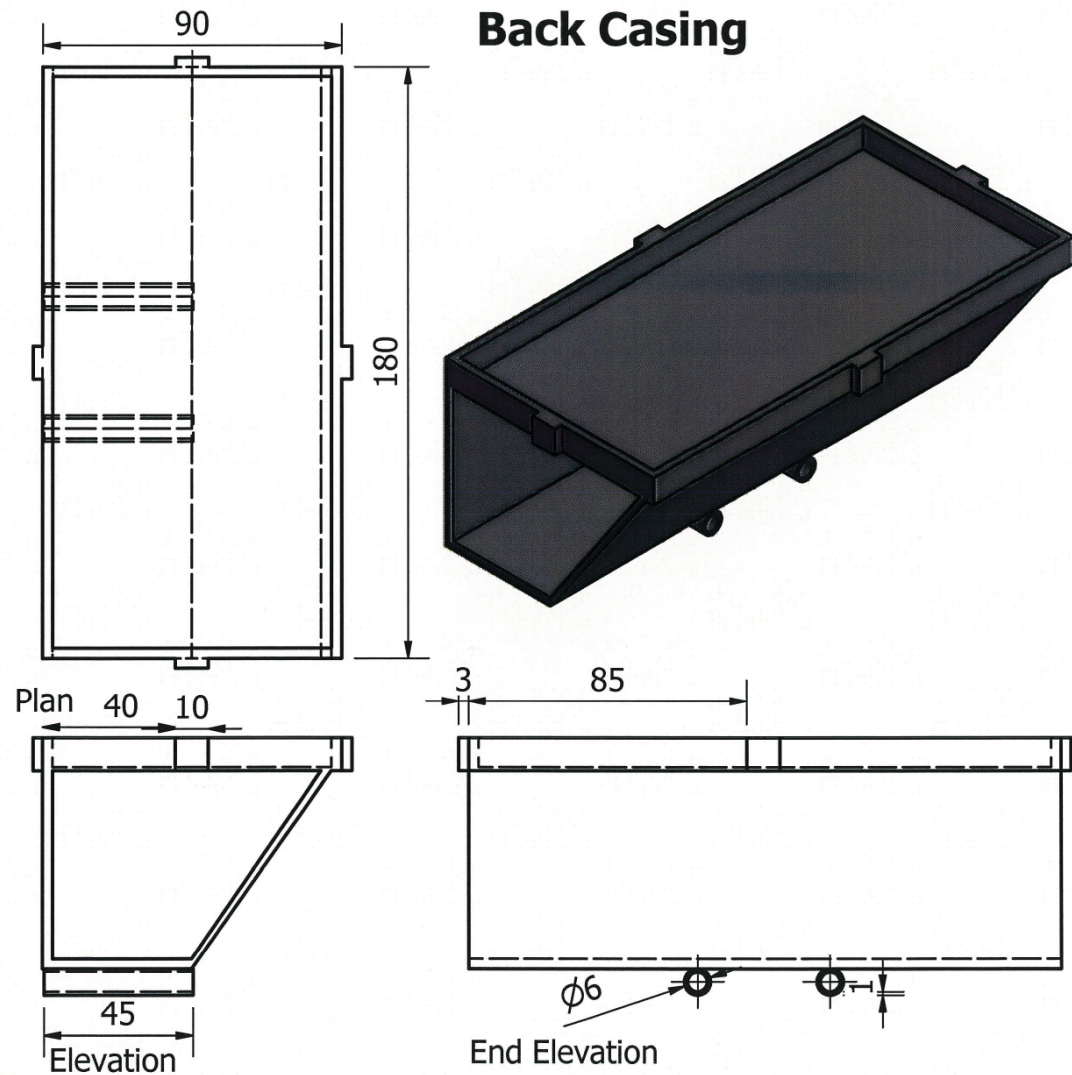

Front Casing

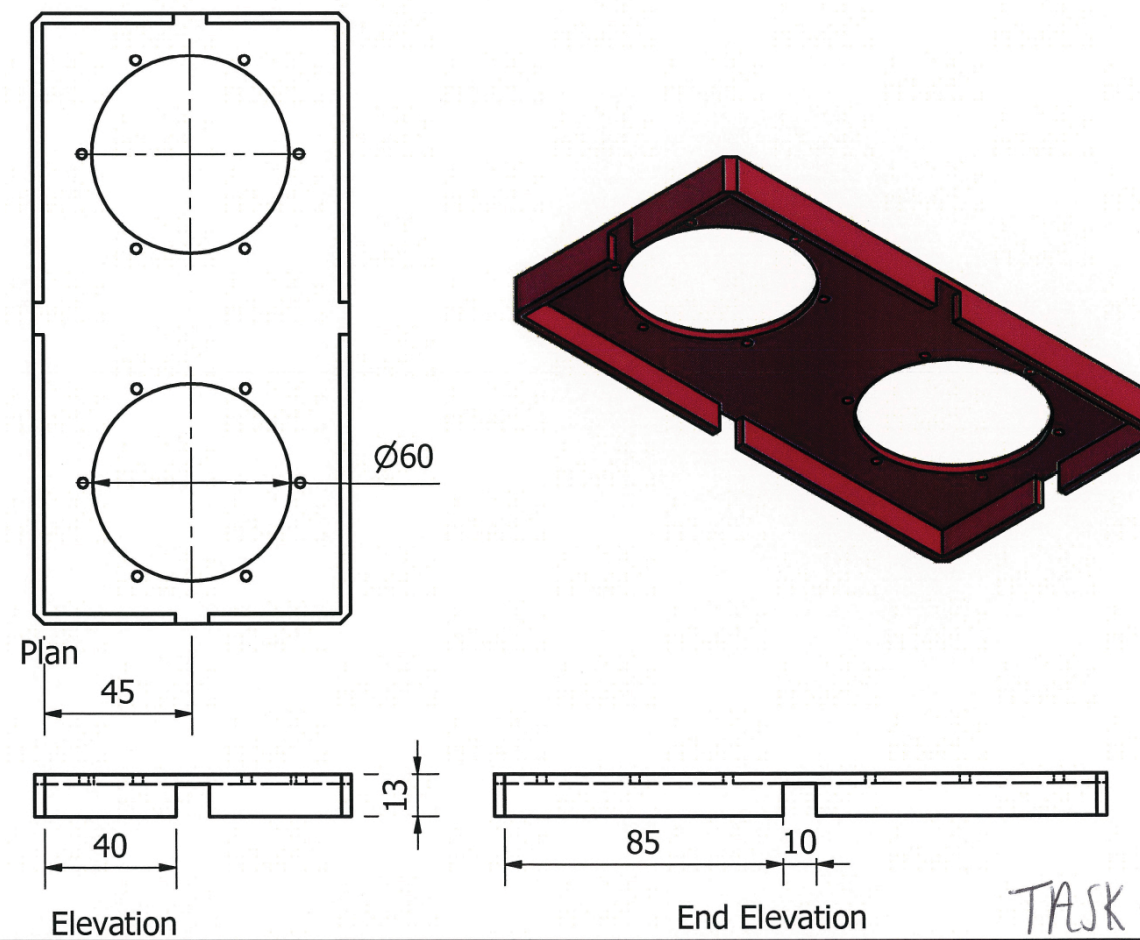

TASK - 1B

NAME:

TITLE: Speaker Components

SCALE: 1:2

All sizes in millimetres unless otherwise stated

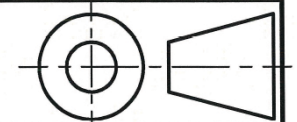

Exploded View of Speaker

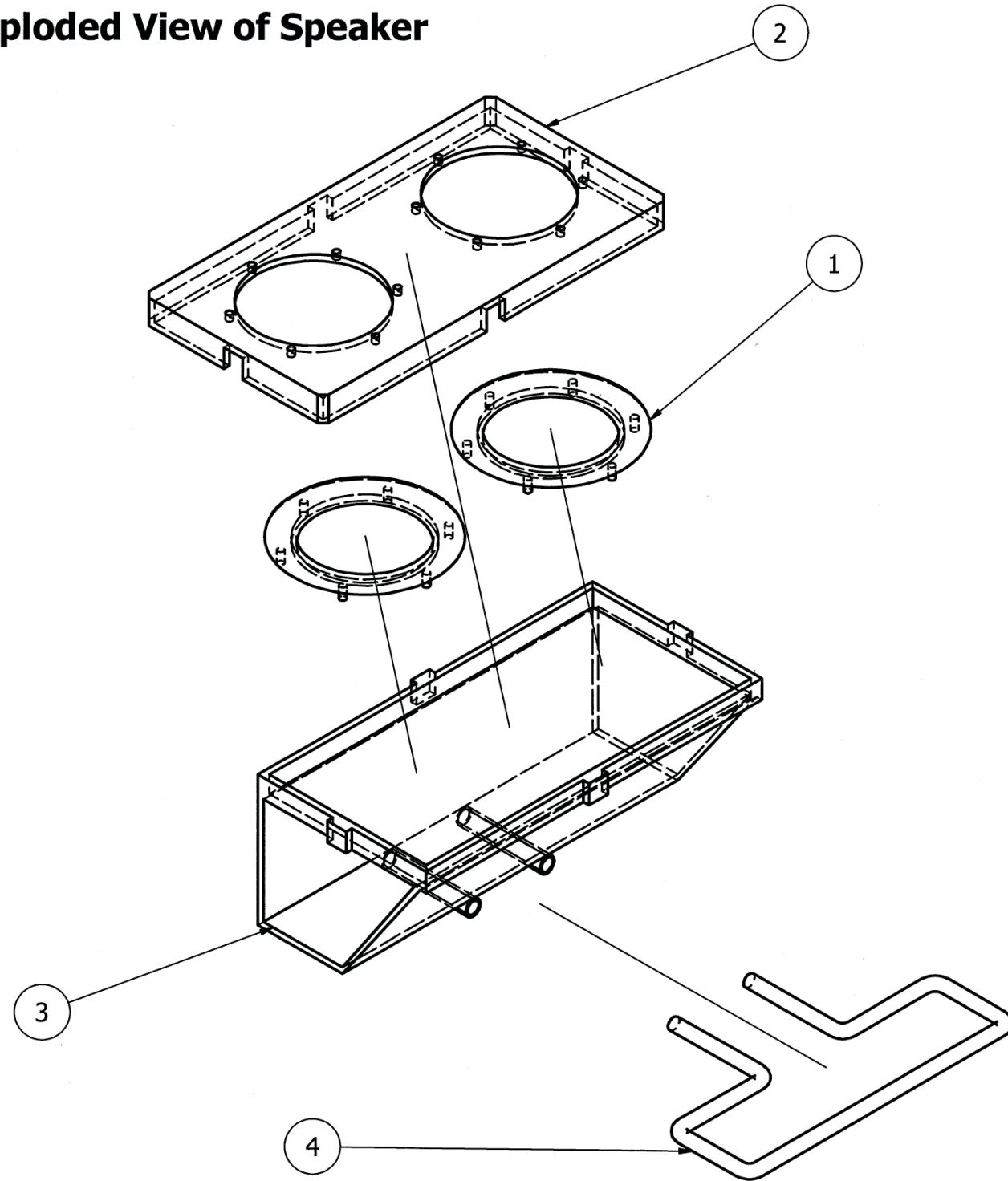

Parts List			
ITEM	QTY	PART NUMBER	DESCRIPTION
1	2	Speaker Disc	
2	1	Front Casing	
3	1	Back Casing	
4	1	Rod	

TASK-1C

NAME:

TITLE: EXPLODED VIEW

SCALE:
All sizes in millimetres unless otherwise stated

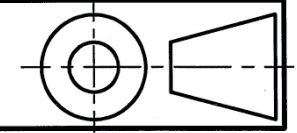



TASK - 2A

PRELIMINARY SKETCHES

THE USE OF DROP SHADOWS CREATING DEPTH AS EMPHASISE IS ON IT

USING THE BLUE BACKGROUND MAKES THE ORANGE STAND OUT AS ITS A RECEDING COLOUR.

CREATES UNITY WRAPPING THE TEXT AROUND SPEAKER

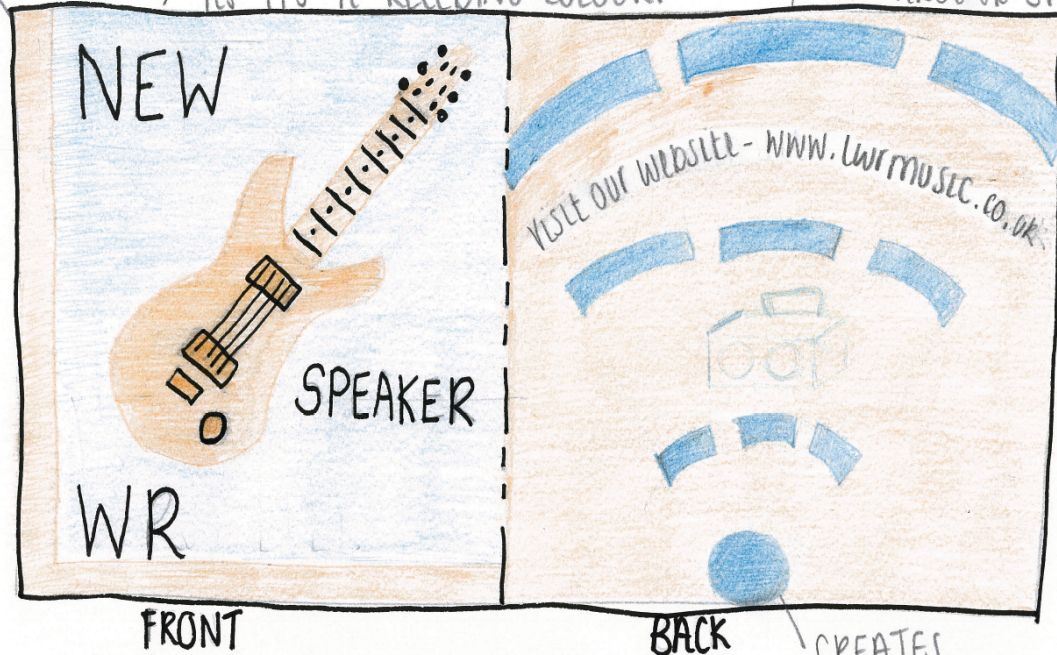

FRONT

BACK

CREATES MOVEMENT IN THE DESIGN

HAVING THIS THIN ORANGE BAND RUNNING THROUGH THE LEAFLET CREATES RHYTHM

THE MUSIC NOTES INCREASING IN SIZE CREATES DEPTH AS IT IS COMING TOWARDS US.

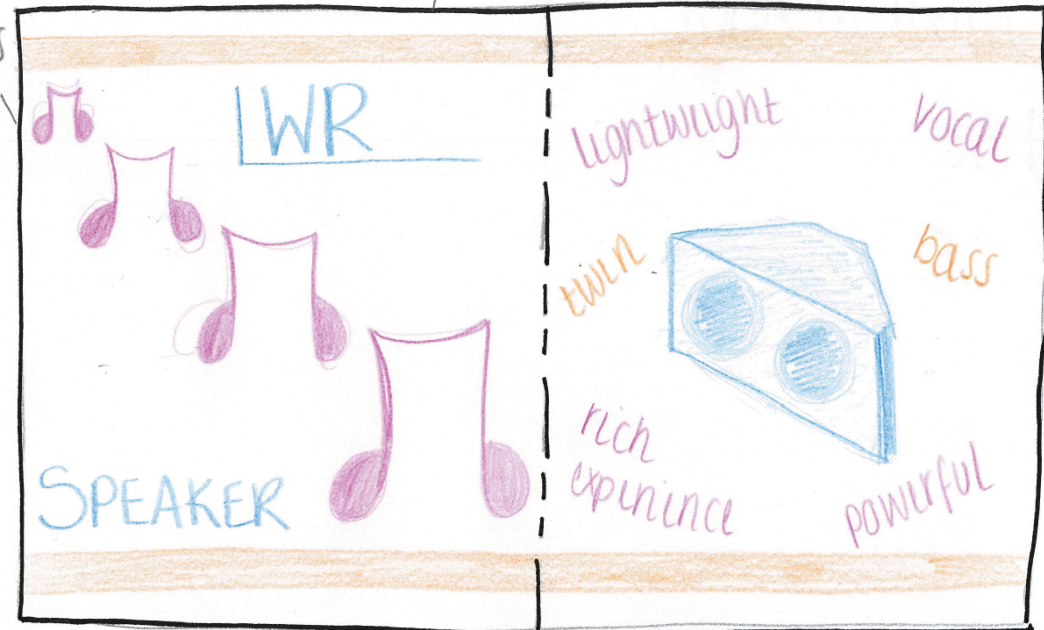

FRONT

BACK

THE WORDS AROUND THE SPEAKER IS CREATING AN EYE CATCHING EFFECT LIKE IT THE SOUND.

DEPTH HAS BEEN USED AS COLOUR HAS BEEN USED IN THE BACKGROUND AND THEN WHITE, CREATING A CONTRAST.

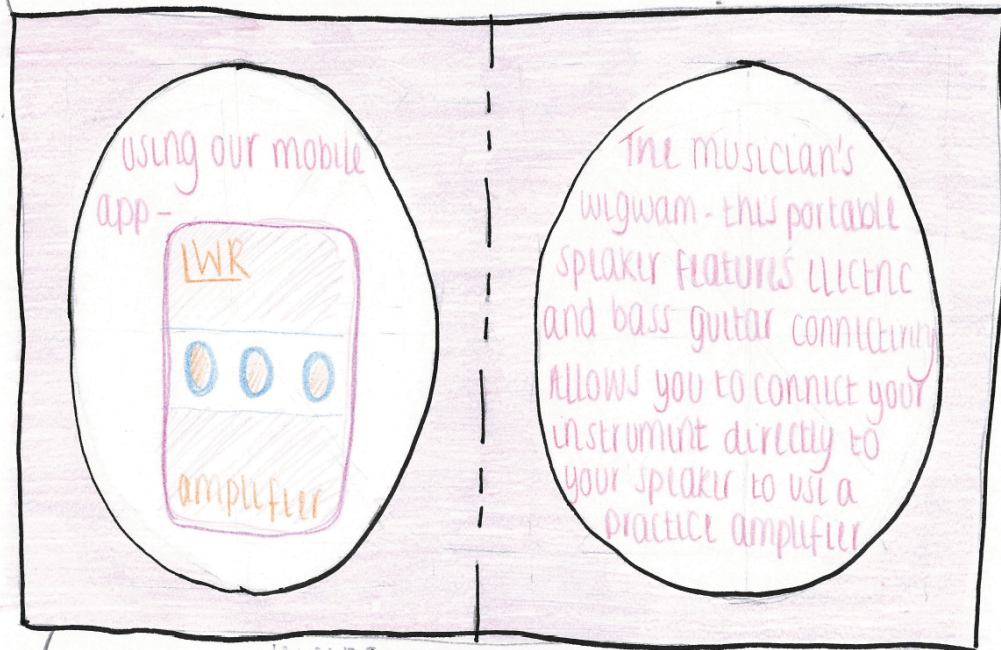

INSIDE INSIDE PAGES

A SYMMETRICAL LAYOUT, WHICH IS EMPHASING A FORMAL DESIGN

THE LAYOUT IS CREATING A LINK WITH THE PRODUCT WE'RE PROMOTING

USING TWO MUSICAL NOTES IS CREATING UNITY, TYING THE DESIGN TOGETHER

HAVING A WHITE BACKGROUND ATTRACTS PEOPLE TO LOOK AT THE FOREGROUND CREATING CONTRAST

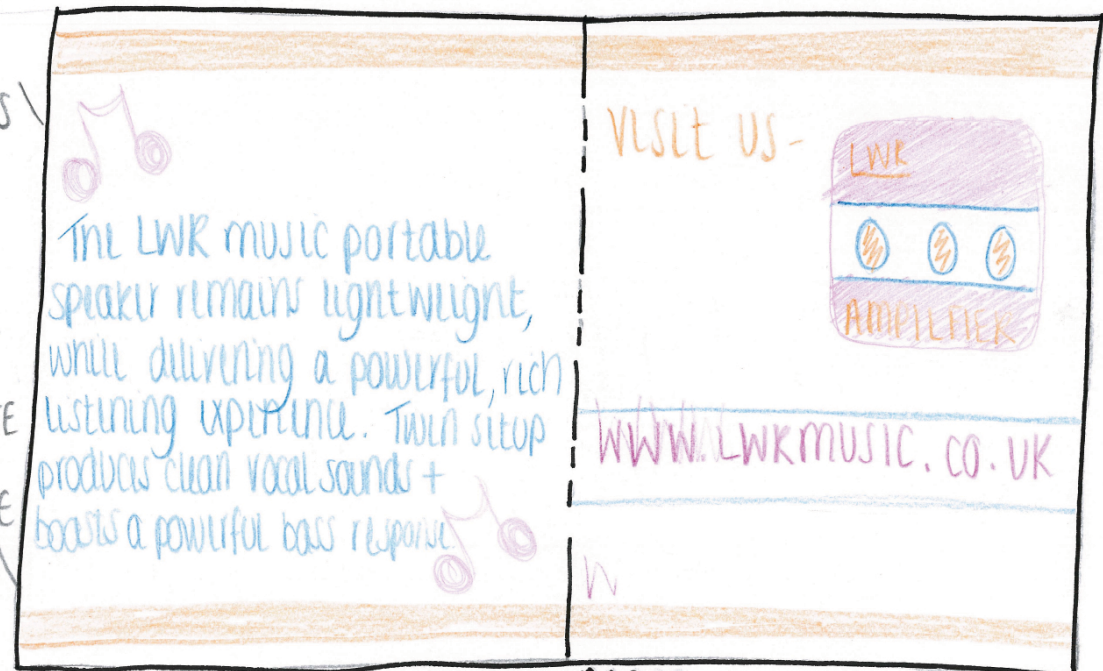

INSIDE PAGES

TASK - 2A B

Task 2b, Front and Back Design

BLUE + ORANGE
CONTRASTING
COLOURS

THE DROP CAPITAL
IS CREATING DOMINANCE



THE FONT SURROUNDING
THE SPEAKER IS
BECOMING BOLDER WHEN
CLOSET TO US CREATES
DEPTH AS IT LOOKS LIKE
IT'S VANISHING.

TRANSPARENCY
USED ON DROP CAPITAL
AND BACKGROUND.

THE MUSICAL NOTE
BORDER IS CREATING
RHYTHM THROUGHOUT
THE DESIGN, AS IT'S LINKING
IT ALL TOGETHER.

Middle Design

ORANGE FONT
STANDS OUT ON
BLACK BACKGROUND
CREATING DEPTH

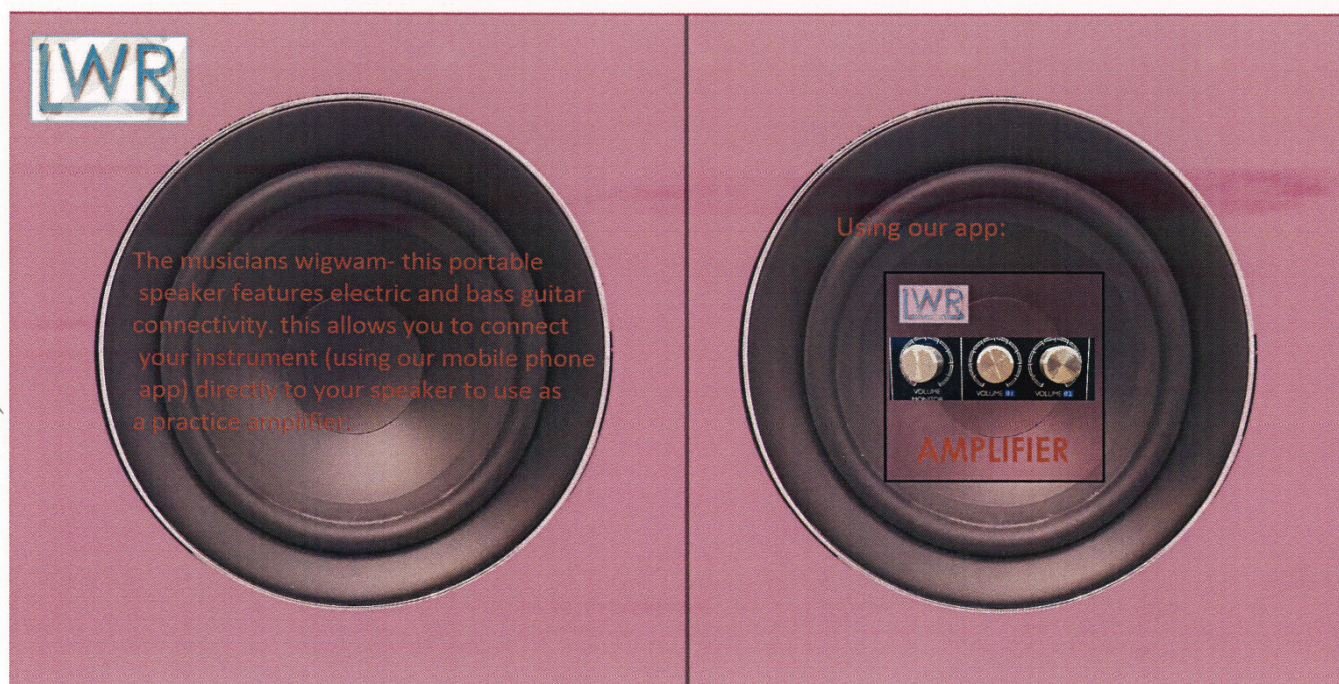

THE SPEAKER
MAKING A BOLD
APPEARANCE

TRANSPARENCY
USED ON THE LOGO

TASK- 2BC

PRELIMINARY SKETCHES - LUGGAGE TAG

DESIGN 1

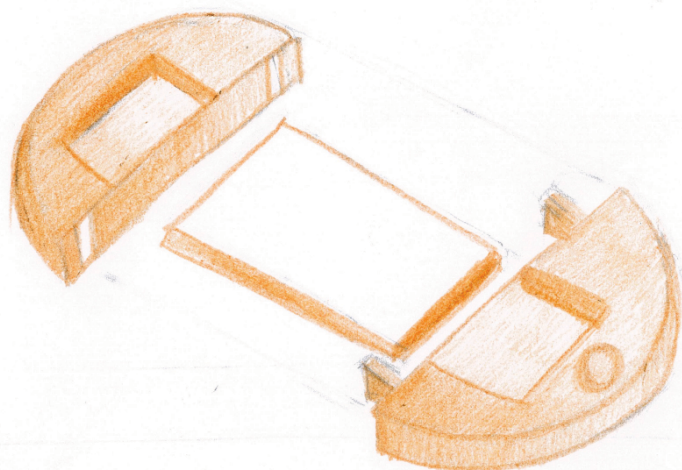

PINK + ORANGE
BOTH LWR COLOURS
- LINKING WITH FUN
HOLIDAY COLOURS

SHADOW BEHIND
THEM CREATING DEPTH.

THE THREE KNOBS
ARE INSPIRED FROM
THE VOLUME KNOBS

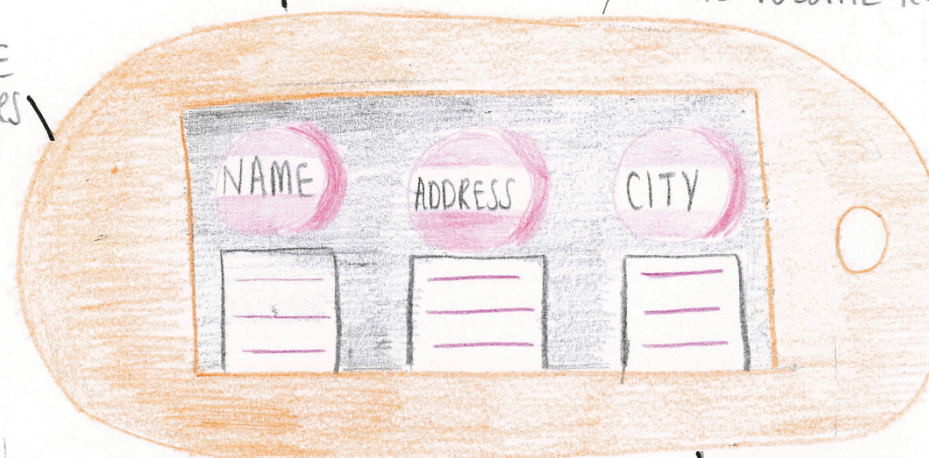

SYMMETRICAL
DESIGN CREATES
FORM

NEUTRAL GREY
BACKGROUND MAKING
THE IMPORTANT PARTS
STAND OUT

STRAIGHT FORWARD
DESIGN, LITTLE
CONFUSION.

BLACK USED TO
MAKE SUBHEADINGS STAND
OUT

BLUE + ORANGE
CONTRASTING COLOURS,
MAKING IT STAND OUT
TO CUSTOMERS

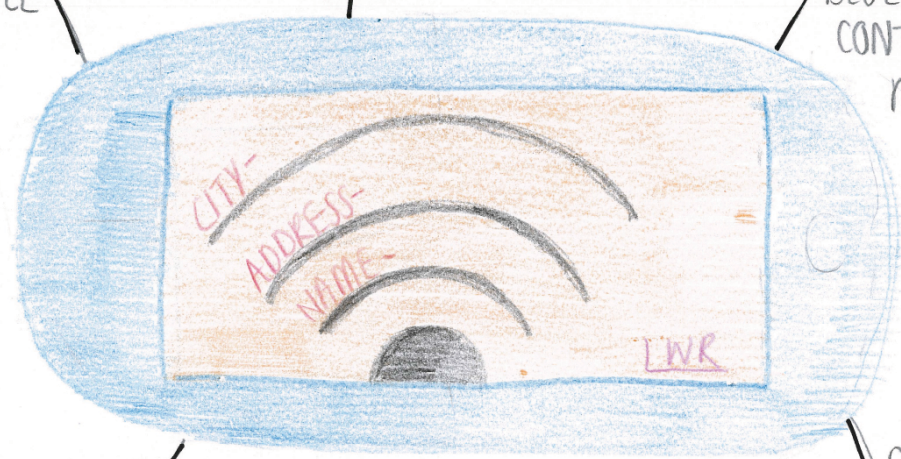

UNITY CREATED
AS TEXT IS FOLLOWING
THE CURVE.

COMPANY RECOGNISED
WITH LOGO

DESIGN 2

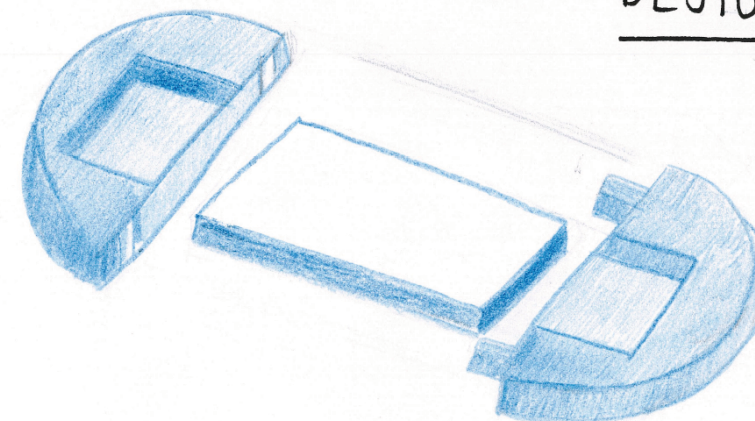

TASK - 3A

Task 3, Front Design

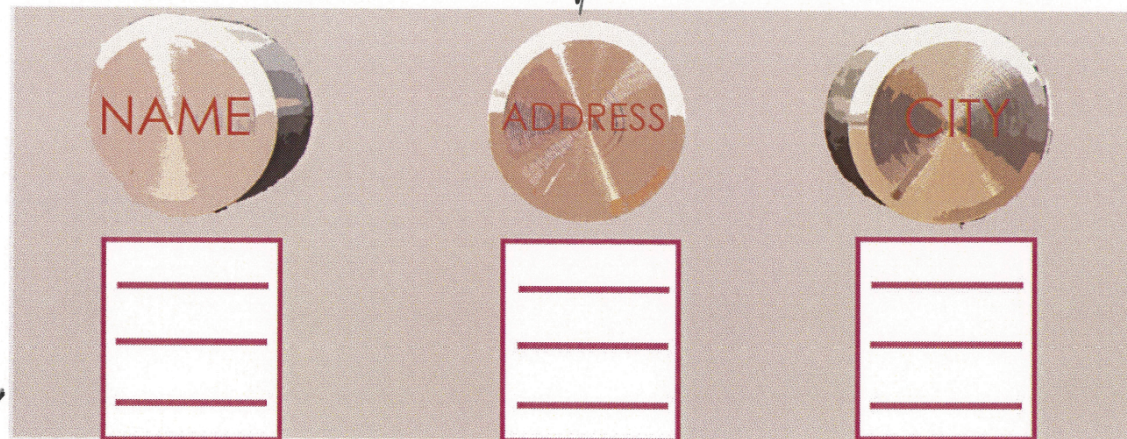

STRAIGHT FORWARD TO USE

COLOUR FILL USED TO CREATE A NATURAL BACKGROUND

THIS DESIGN IS VERY SYMMETRICAL CREATING A FORMAL LOOK

Back Design



SHADOWS CREATING DEPTH TO THE LOGO

DROP CAPITAL USED TO EMPHASISE THE WORD AND MAKE IT MORE EYE CATCHING

ROTATE USED TO SPIN THE LOGO AT THIS ANGLE

TRANSPARENCY USED TO BLEND LOGO INTO BACKGROUND

TRANSPARENCY ALSO USED TO EMPHASISE THE SOUND GOING OUT

BLUE + ORANGE ARE CONTRASTING COLOURS SO MAKE EACH OTHER STAND OUT

TASK-3B